



Peareswood Gardens

Stanmore

£795,000

A four bedroom, two bathroom semi detached house available in excellent condition with Davidson Frost-Wellings.

The property is superbly located within easy access of Canons Park and Queensbury stations, as well as numerous regular bus routes, all providing exceptional links into Central London and to the surrounding area. There are a variety of shops and amenities within a short distance, and the area is well served by good local schools and beautiful open spaces.

Harrow council tax band E

Viewing

Please contact our Davidson Frost-Wellings Office on 020 8954 8806 if you wish to arrange a viewing appointment for this property or require further information.

- Four bedrooms
- Two bathrooms
- Superb condition
- Off street parking
- Good sized garden
- Sought after location



Floor Plan

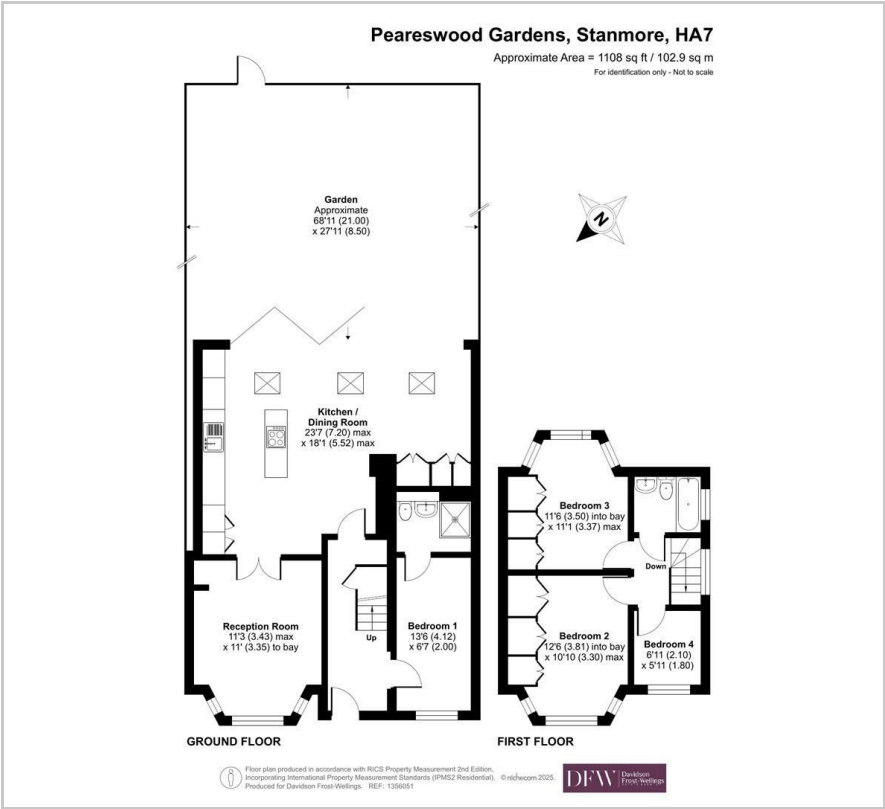

Area Map

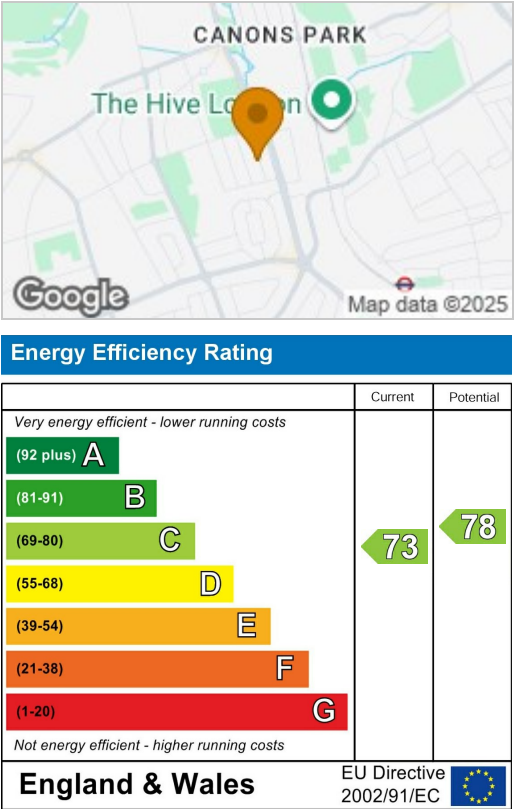

These particulars, whilst believed to be accurate are set out as a general outline only for guidance and do not constitute any part of an offer or contract. Intending purchasers should not rely on them as statements of representation of fact, but must satisfy themselves by inspection or otherwise as to their accuracy. No person in this firms employment has the authority to make or give any representation or warranty in respect of the property.